

24.934.*

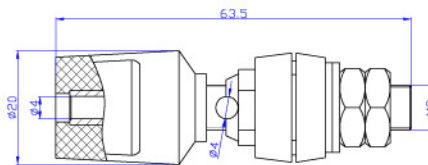

Material

Insulator:ABS
 Body:Brass
 Surface:Nickel plated
Rated voltage/current
 30Vac-60Vdc/Max.60A



24.935.*



Material

Insulator:ABS
 Body:Brass
 Surface:Nickel plated
Rated voltage/current
 30Vac-60Vdc/Max.80A

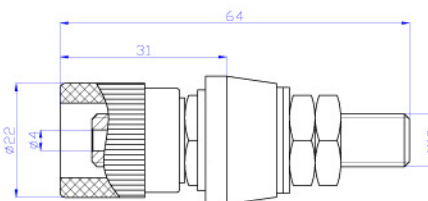

24.936.*



Material

Insulator:ABS
 Body:Brass
 Surface:Nickel plated
Rated voltage/current
 30Vac-60Vdc/Max.100A

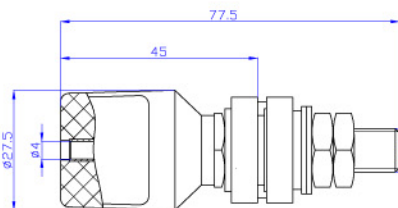

24.937.*



Material

Insulator:ABS
 Body:Brass
 Surface:Nickel plated
Rated voltage/current
 30Vac-60Vdc/Max.150A

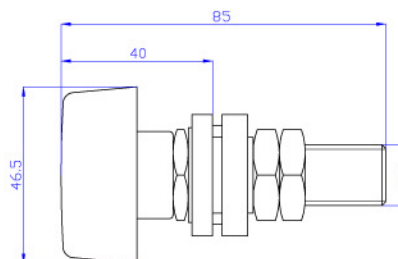

25.101. *



Material
 Insulator:PVC
 Body:Brass
 Surface:Gold plated
 *Solder connection
Rated voltage/current
 30Vac-60Vdc/Max.6A

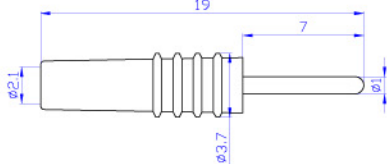

25.204. *



Material
 Insulator:PE
 Body:Brass
 Surface:Nickel plated
 *Solder connection
Rated voltage/current
 30Vac-60Vdc/Max.10A

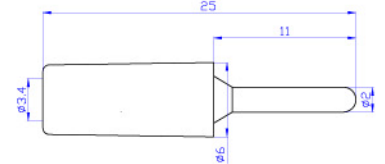

25.201. *



Material
 Insulator:PVC
 Body:Brass
 Spring:Beryllium copper
 Surface:Gold plated
 *Solder connection
Rated voltage/current
 30Vac-60Vdc/Max.10A

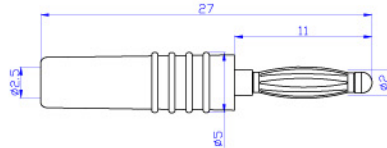

25.205. *



Material
 Insulator:PVC
 Body:Brass
 Spring:Beryllium copper
 Surface:Gold plated
 *Solder connection
Rated voltage/current
 30Vac-60Vdc/Max.10A

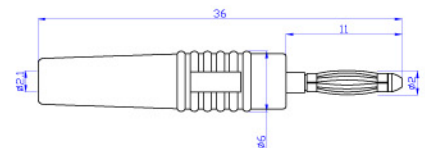

25.202. *



Material
 Insulator:PE
 Body:Brass
 Spring:Beryllium copper
 Surface:Gold plated
 *Solder connection
Rated voltage/current
 30Vac-60Vdc/Max.12A

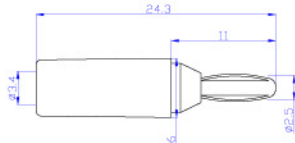

25.206. *



Material
 Insulator:PE
 Body:Brass
 Spring:Beryllium copper
 Surface:Gold plated
 *Solder connection
Rated voltage/current
 30Vac-60Vdc/Max.10A

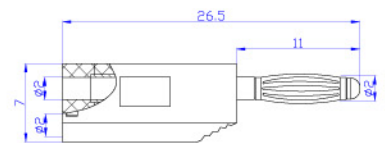

25.203. *



Material
 Insulator:PE
 Body:Brass
 Spring:Beryllium copper
 Surface:Gold plated
 *Solder connection
Rated voltage/current
 30Vac-60Vdc/Max.10A

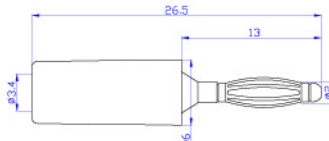

25.207. *



Material
 Insulator:PE
 Body:Brass
 Spring:Beryllium copper
 Surface:Gold plated
 *Solder connection
Rated voltage/current
 30Vac-60Vdc/Max.10A

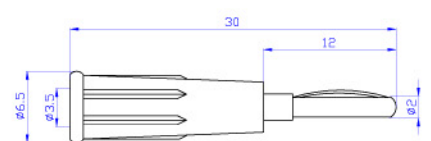

25.208. *



Material
 Insulator:PA
 Body:Brass
 Spring:Beryllium copper
 Surface:Nickel plated
 *Solder connection
Rated voltage/current
 CATII 600V/Max.10A

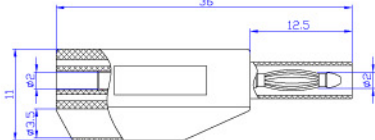

25.410. *



Material
 Insulator:PVC
 Body:Brass
 Spring:Steel
 Surface:Nickel plated
 *Screw connection
Rated voltage/current
 30Vac-60Vdc/Max.24A

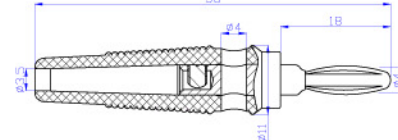

25.401. *



Material
 Insulator:ABS
 Body:Brass
 Spring:Beryllium copper
 Surface:Nickel plated
 *Screw connection
Rated voltage/current
 30Vac-60Vdc/Max.24A

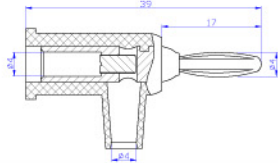

25.411. *



Material
 Insulator:PVC
 Body:Brass
 Spring:Steel
 Surface:Nickel plated
 *Screw connection
Rated voltage/current
 30Vac-60Vdc/Max.24A

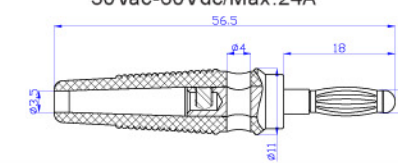

25.402. *



Material
 Insulator:ABS
 Body:Brass
 Spring:Phosphorus copper
 Surface:Nickel plated
 *Solder connection
Rated voltage/current
 30Vac-60Vdc/Max.19A

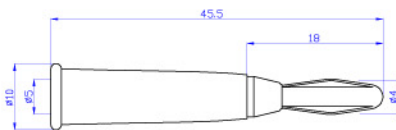

25.412. *



Material
 Insulator:PVC
 Body:Brass
 Spring:Beryllium copper
 Surface:Nickel plated
 *Screw connection
Rated voltage/current
 30Vac-60Vdc/Max.24A

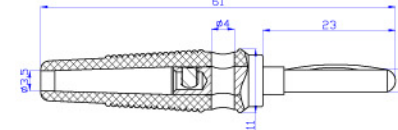

25.403. *



Material
 Insulator:PE
 Body:Brass
 Spring:Beryllium copper
 Surface:Nickel plated
 *Screw connection
Rated voltage/current
 30Vac-60Vdc/Max.32A

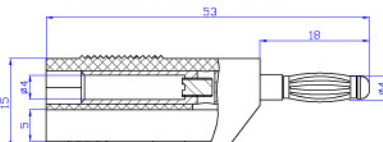

25.413. *



Material
 Insulator:PVC
 Body:Brass
 Spring:Phosphorus copper
 Surface:Nickel plated
 *Screw connection
Rated voltage/current
 30Vac-60Vdc/Max.32A

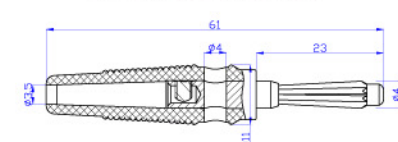

25.414. *



Material
 Insulator:PVC
 Body:Brass
 Surface:Nickel plated
 *Screw connection
Rated voltage/current
 30Vac-60Vdc/Max.32A

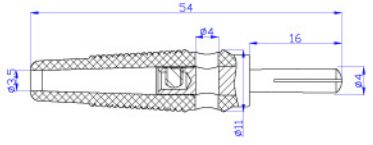

25.422. *



Material
 Insulator:PA
 Body:Brass
 Spring:Beryllium copper
 Surface:Gold plated
 *Solder connection
Rated voltage/current
 30Vac-60Vdc/Max.24A

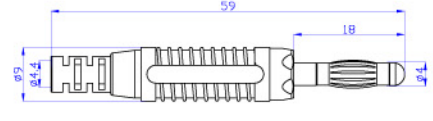

25.415. *



Material
 Insulator:PVC
 Body:Brass
 Surface:Nickel plated
 *Screw connection
Rated voltage/current
 30Vac-60Vdc/Max.24A

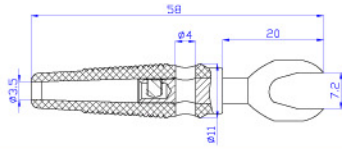

25.425. *



Material
 Insulator:PE
 Body:Beryllium copper
 Spring:Beryllium copper
 Surface:Gold plated
 *Solder connection
Rated voltage/current
 30Vac-60Vdc/Max.19A

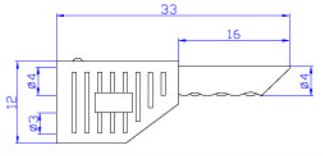

25.420. *



Material
 Insulator:ABS
 Body:Brass
 Surface:Nickel plated
 *Screw connection
Rated voltage/current
 30Vac-60Vdc/Max.24A

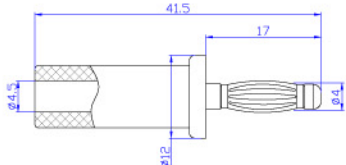

25.426. *



Material
 Insulator:PE
 Body:Brass
 Spring:Steel
 Surface:Nickel plated
 *Solder connection
Rated voltage/current
 30Vac-60Vdc/Max.19A

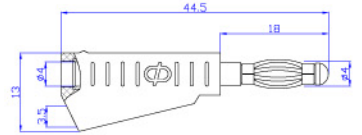

25.421. *



Material
 Insulator:ABS
 Body:Brass
 Surface:Nickel plated
 *Solder connection
Rated voltage/current
 30Vac-60Vdc/Max.24A

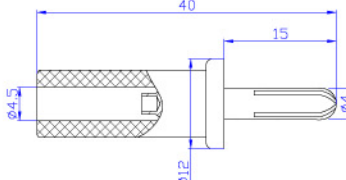

25.430. *



Material
 Insulator:PVC
 Body:Brass
 Surface:Nickel plated
 *Screw connection
Rated voltage/current
 30Vac-60Vdc/Max.24A

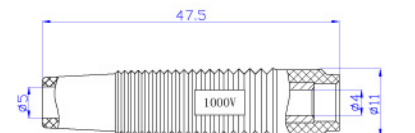

25.431. *



Material
 Insulator:PA
 Body:Brass
 Surface:Nickel plated
 *Solder connection
Rated voltage/current
 30Vac-60Vdc/Max.24A

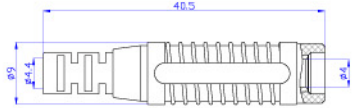

25.502. *



Material
 Insulator:PA
 Body:Brass
 Spring:Beryllium copper
 Surface:Nickel plated
 *Solder connection
Rated voltage/current
 CATII 1000V/Max.32A

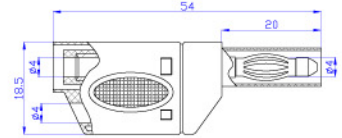

25.450. *



Material
 Insulator:PA
 Body:Brass
 Spring:Beryllium copper
 Surface:Nickel plated
 *Solder connection
Rated voltage/current
 CATII 600V/Max.32A

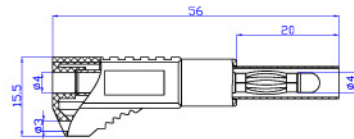

25.503. *



Material
 Insulator:PA
 Body:Brass
 Spring:Beryllium copper
 Surface:Nickel plated
 *Solder connection
Rated voltage/current
 CATII 1000V/Max.32A

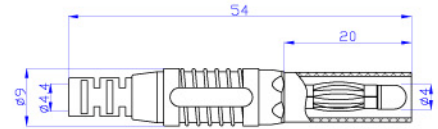

25.451. *



Material
 Insulator:PA
 Body:Brass
 Spring:Beryllium copper
 Surface:Nickel plated
 *Press connection
Rated voltage/current
 30Vac-60Vdc/Max.32A

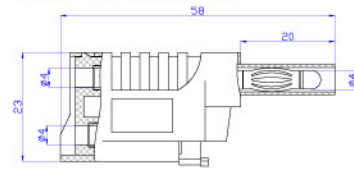

25.504. *



Material
 Insulator:PA
 Body:Brass
 Spring:Beryllium copper
 Surface:Nickel plated
 *Solder connection
Rated voltage/current
 CATII 1000V/Max.32A

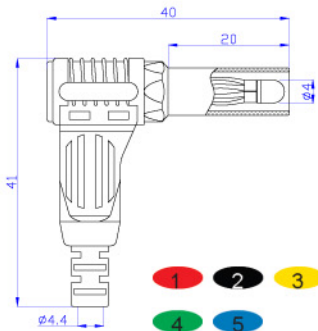

25.501. *



Material
 Insulator:PA
 Body:Brass
 Spring:Beryllium copper
 Surface:Nickel plated
 *Solder connection
Rated voltage/current
 CATII 600V/Max.32A

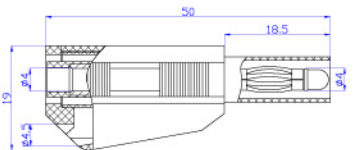

25.505. *



Material
 Insulator:PA
 Body:Brass
 Surface:Nickel plated
 *Solder connection
Rated voltage/current
 CATII 600V/Max.19A

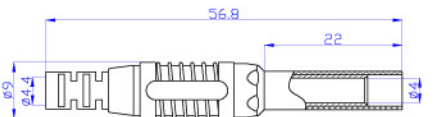

26.221.*



Material
 Insulator: ABS
 Body: Brass
 Spring: Beryllium copper
 Surface: Nickel plated
Rated voltage/current
 CAT II 1000V/Max.32A

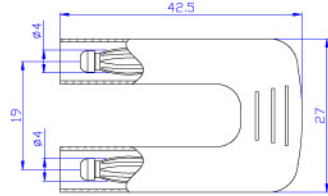

2

26.460.*

Material

Body: Brass
 Spring: Beryllium copper
 Surface: Nickel plated

Rated voltage/current
 30Vac-60Vdc/Max.32A

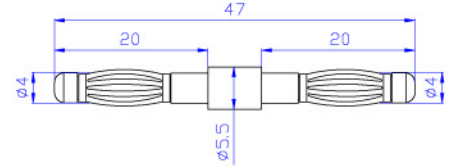

26.222.*



Material
 Insulator: PA
 Body: Brass
 Spring: Beryllium copper
 Surface: Nickel plated
Rated voltage/current
 CAT II 1000V/Max.32A

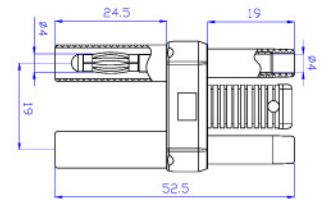

2

26.410.*



Material
 Insulator: PVC
 Body: Brass
 Surface: Nickel plated
Rated voltage/current
 30Vac-60Vdc/Max.19A

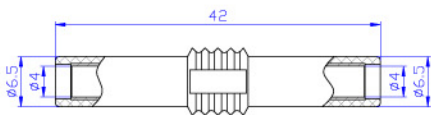

26.420.*



Material
 Insulator: PVC
 Body: Brass
 Surface: Nickel plated
Rated voltage/current
 30Vac-60Vdc/Max.24A

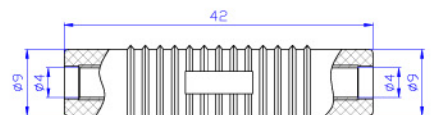

26.450.*



Material
 Insulator:PA
 Body:Brass
 Surface:Nickel plated
Rated voltage/current
 30Vac-60Vdc/Max.36A

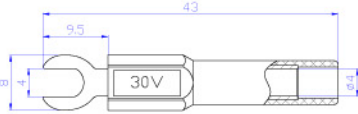

26.454.*



Material
 Insulator:PA
 Body:Brass
 Surface:Nickel plated
Rated voltage/current
 30Vac-60Vdc/Max.10A

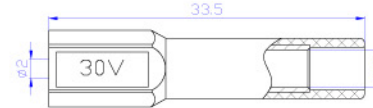

26.451.*



Material
 Insulator:PA
 Body:Brass
 Surface:Nickel plated
Rated voltage/current
 30Vac-60Vdc/Max.36A

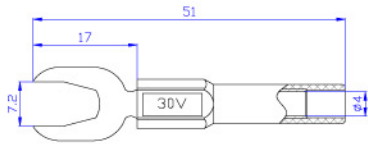

26.455.*



Material
 Insulator:PA
 Body:Brass
 Spring:Beryllium copper
 Surface:Nickel plated
Rated voltage/current
 30Vac-60Vdc/Max.10A

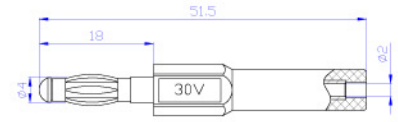

26.452.*



Material
 Insulator:PA
 Body:Brass
 Spring:Beryllium copper
 Surface:Gold plated
Rated voltage/current
 30Vac-60Vdc/Max.36A

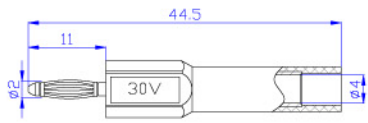

26.456.*



Material
 Insulator:PA
 Body:Brass
 Spring:Beryllium copper
 Surface:Nickel plated
Rated voltage/current
 30Vac-60Vdc/Max.10A

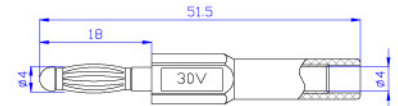

26.453.*



Material
 Insulator:PA
 Body:Brass
 Spring:Beryllium copper
 Surface:Gold plated
Rated voltage/current
 30Vac-60Vdc/Max.10A

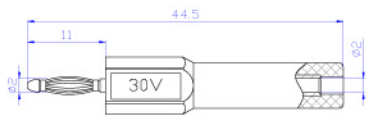

26.457



Material
 Insulator:PA
 Body:Brass
 Spring:Beryllium copper
 Surface:Nickel plated
Rated voltage/current
 30Vac-60Vdc/Max.10A

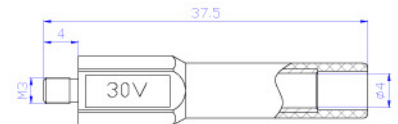

26.458.*



Material

Insulator: PA
 Body: Brass
 Spring: Beryllium copper
 Surface: Nickel plated

Rated voltage/current

30Vac-60Vdc/Max.36A

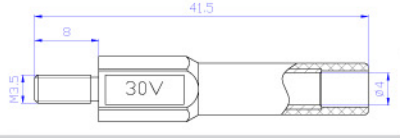

26.459.*



Material

Insulator: PA
 Body: Brass
 Spring: Beryllium copper
 Surface: Nickel plated

Rated voltage/current

30Vac-60Vdc/Max.36A

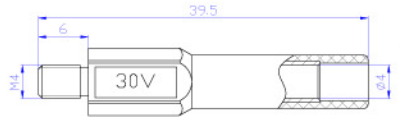

26.470.*



Material

Insulator: PA
 Body: Brass
 Surface: Nickel plated

Rated voltage/current

30Vac-60Vdc/Max.10A

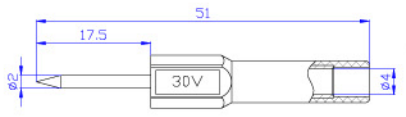

Material

Body: Brass
 Surface: Gold plated

Rated voltage/current

30Vac-60Vdc/Max.32A



26.480

26.481

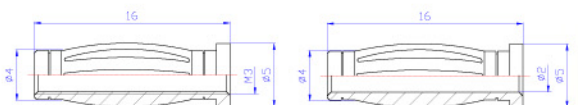

27.187.*



Material
 Insulator: PA
 Body: Brass
 Surface: Nickel plated
Rated voltage/current
 30Vac-60Vdc/Max.10A

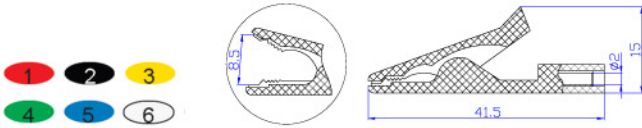

27.259.*



Material
 Insulator: ABS
 Body: Steel
 Surface: Nickel plated
Rated voltage/current
 30Vac-60Vdc/Max.19A

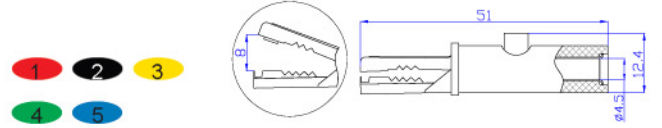

27.258.*



Material
 Insulator: PA
 Body: Brass
 Surface: Nickel plated
Rated voltage/current
 CATII 300V/Max.15A

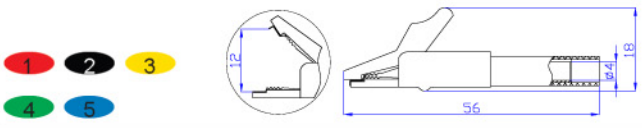

27.320.*



Material
 Insulator: ABS
 Body: Brass
 Surface: Gold plated

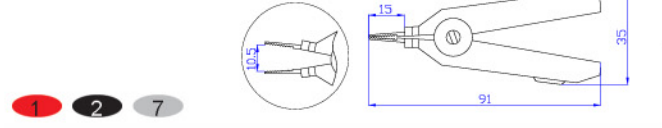

27.262.*



Material
 Insulator: PA
 Body: Brass
 Surface: Nickel plated
Rated voltage/current
 CATIII 1000V/Max.32A

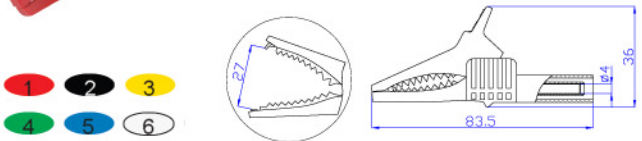

27.330.*



Material
 Insulator: PVC
 Body: Brass
 Surface: Nickel plated

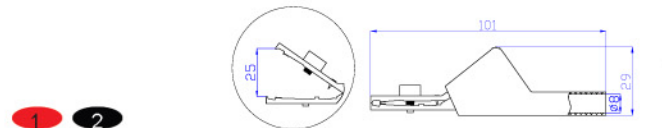

27.263.*



Material
 Insulator: PA
 Body: Brass
 Surface: Nickel plated
Rated voltage/current
 CATIII 1000V/Max.32A

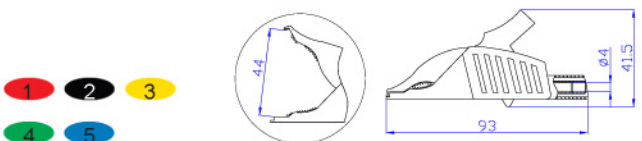

27.710/711/712.*



Material
 Insulator: PVC
 Body: Steel
 Surface: Nickel plated

